



Stable Flat West Wylze, Warminster, Wiltshire, BA12 0QD

A well presented, one bedroom first floor apartment with electric heating situated on private rural estate in the popular Wylze Valley. SINGLE OCCUPANCY ONLY. Parking for one car.

- Refurbished in 2023
- First floor flat via outside steps
- One double bedroom
- En-suite shower room (no bath)
- Fully double glazed
- Water, sewerage and Wi-Fi included
- Single occupancy only
- Electric heating
- Rural estate location
- Potentially long term

£725 PCM

First Floor

Approx. 39.7 sq. metres (427.2 sq. feet)

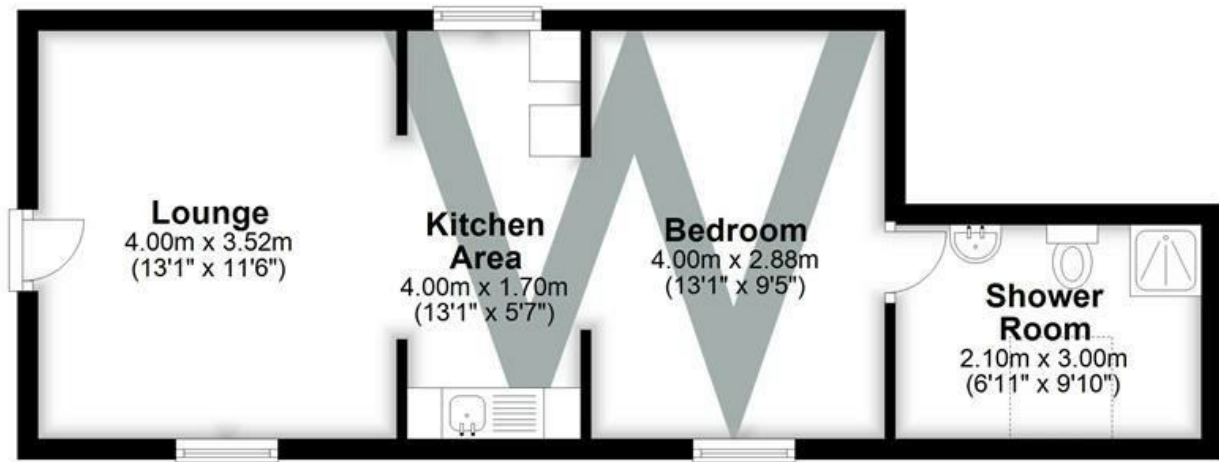

WHITES

Castle Chambers, 47 Castle Street, Salisbury,
Wiltshire, SP1 3SP

Tel: 01722 336422/Option 2

www.hwwhite.co.uk

email: lettings-management@hwwhites.co.uk

| Energy Efficiency Rating | | |
|---------------------------------------------|---------|-----------|
| | Current | Potential |
| Very energy efficient - lower running costs | | |
| (92 plus) A | | |
| (81-91) B | | |
| (69-80) C | | |
| (55-68) D | | |
| (39-54) E | | |
| (21-38) F | | |
| (1-20) G | | |
| Not energy efficient - higher running costs | | |
| England & Wales | 59 | 71 |
| EU Directive 2002/91/EC | | |

| Environmental Impact (CO ₂) Rating | | |
|-----------------------------------------------------------------|---------|-----------|
| | Current | Potential |
| Very environmentally friendly - lower CO ₂ emissions | | |
| (92 plus) A | | |
| (81-91) B | | |
| (69-80) C | | |
| (55-68) D | | |
| (39-54) E | | |
| (21-38) F | | |
| (1-20) G | | |
| Not environmentally friendly - higher CO ₂ emissions | | |
| England & Wales | | |
| EU Directive 2002/91/EC | | |